



Code	T1002MY	T1002MX	T1102MY	T1102MX	T1202MY	T1202MX	T1302MY	T1302MX	T1402MY	T1402MX	T1502MY	T1502MX	T2002
Coating													
DIN	ZYA-S	ZYA-S	WRC	WRC	SPG	SPG	RBF	RBF	KUD	KUD	SKM	SKM	
Type	MY	MX	MY	MX	MY	MX	MY	MX	MY	MX	MY	MX	W
Material	SC	SC	SC	SC	SC	SC	SC	SC	SC	SC	SC	SC	SC
Dimens. (mm)	3-12	3-12	3-12	3-12	3-12	3-12	3-12	3-12	3-12	3-12	3-12	3-12	2-12
Page	2	2	2	2	3	3	3	3	4	4	5	5	7

P	P.1		•		•		•		•		•		•	
	P.2		•		•		•		•		•		•	
	P.3	•	•	•	•	•	•	•	•	•	•	•	•	•
	P.4		•		•		•		•		•		•	
	P.5	•	•	•	•	•	•	•	•	•	•	•	•	•
	P.6	•	•	•	•	•	•	•	•	•	•	•	•	•
M	M.1	•		•		•		•		•		•		•
	M.2	•		•		•		•		•		•		•
	M.3	•		•		•		•		•		•		•
K	K.1	•	•	•	•	•	•	•	•	•	•	•	•	•
	K.2	•	•	•	•	•	•	•	•	•	•	•	•	•
N	N.1		•		•		•		•		•		•	
	N.2		•		•		•		•		•		•	
	N.3		•		•		•		•		•		•	
	N.4		•		•		•		•		•		•	
	N.5		•		•		•		•		•		•	•
S	S.1		•		•		•		•		•		•	
	S.2	•	•	•	•	•	•	•	•	•	•	•	•	•
H	H.1	•		•		•		•		•		•		•
	H.2	•		•		•		•		•		•		•

Rotary burrs SC



T1002

T1102

MY

T1002

CZ Technické frézy SK | SK

DE Frässtifte VHM

RU Бор-Фрезы твердосплавные

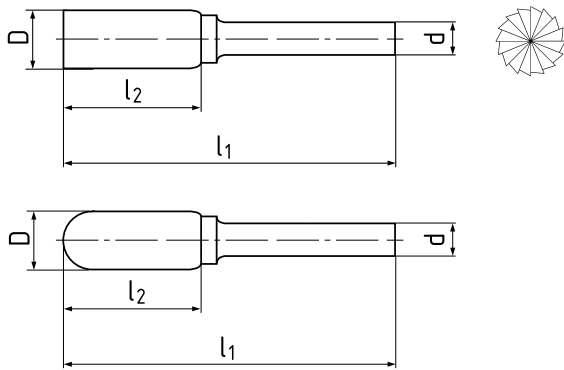

T1002

T1102

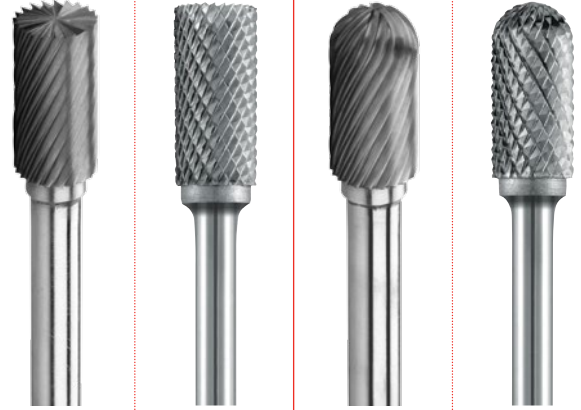

D	d	l1	l2	T1002MY	T1002MX	T1102MY	T1102MX
3	3	38	14	.030	.030	.030	.030
6	6	50	16	.060	.060	.060	.060
8	6	65	20	.080	.080	.080	.080
10	6	65	20	.100	.100	.100	.100
12	6	70	25	.120	.120	.120	.120

MY P.3 P.5 P.6 M.1 M.2 M.3 K.1 K.2 S.2 H.1 H.2

MX P.1 P.2 P.3 P.4 P.5 P.6 K.1 K.2 N.1 N.2 N.3 N.4 S.1 S.2

Rotary burrs SC

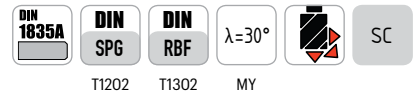

CZ Technické frézy SK | SK
DE Frässtifte VHM
RU Бор-Фрезы твердосплавные

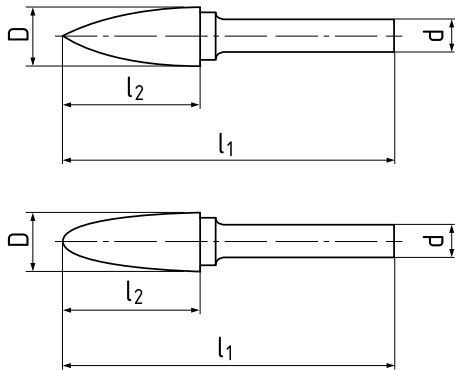

T1202

T1302

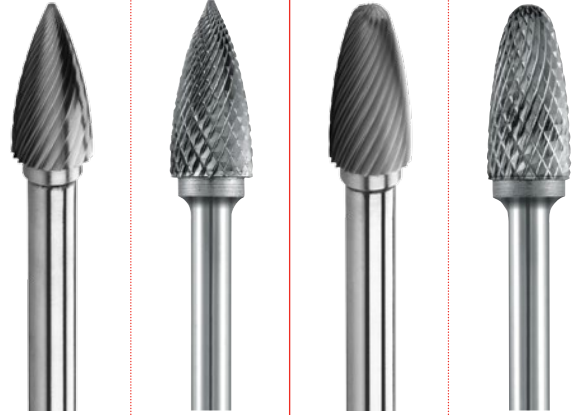

D	d	l1	l2	T1202MY	T1202MX	T1302MY	T1302MX
3	3	38	14	.030	.030	.030	.030
6	6	50	16	.060	.060	.060	.060
8	6	65	20	.080	.080	.080	.080
10	6	65	20	.100	.100	.100	.100
12	6	70	25	.120	.120	.120	.120

MY P.3 P.5 P.6 M.1 M.2 M.3 K.1 K.2 S.2 H.1 H.2

MX P.1 P.2 P.3 P.4 P.5 P.6 K.1 K.2 N.1 N.2 N.3 N.4 S.1 S.2

Rotary burrs SC



MY

CZ Technické frézy SK | SK

DE Frässtifte VHM

RU Бор-Фрезы твердосплавные

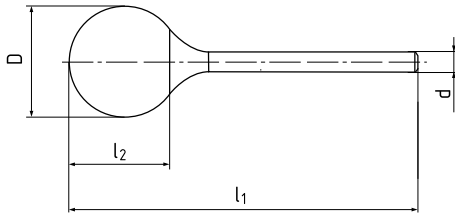

T1402

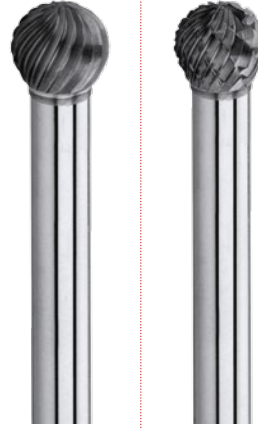

D	d	l1	l2	T1402MY	T1402MX
3	3	38	2,6	.030	.030
6	6	50	5	.060	.060
8	6	51	7	.080	.080
10	6	53	8	.100	.100
12	6	56	11	.120	.120

MY P.3 P.5 P.6 M.1 M.2 M.3 K.1 K.2 S.2 H.1 H.2

MX P.1 P.2 P.3 P.4 P.5 P.6 K.1 K.2 N.1 N.2 N.3 N.4 S.1 S.2

Rotary burrs SC



MY

CZ Technické frézy SK | SK

DE Frässtifte VHM

RU Бор-Фрезы твердосплавные

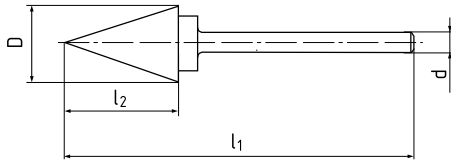

T1502

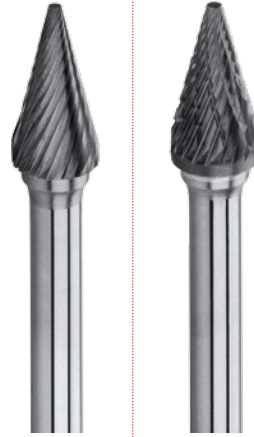

D	d	l1	l2	T1502MY	T1502MX
3	3	38	10	.030100	.030100
6	6	50	12	.060120	.060120
6	6	50	15	.060150	.060150
6	6	50	19	.060190	.060190
10	6	61	16	.100160	.100160
12	6	67	25	.120250	.120250

MY P.3 P.5 P.6 M.1 M.2 M.3 K.1 K.2 S.2 H.1 H.2

MX P.1 P.2 P.3 P.4 P.5 P.6 K.1 K.2 N.1 N.2 N.3 N.4 S.1 S.2

Set of rotary burrs SC

type MX



CZ Sada technických fréz SK | typ MX

DE Satz Frästäbte VHM | Typ MX

RU Набор Бор-Фрезы твердосплавные | тип MX

T1X02



D	d	l1	l2	DIN	.SET01
10	6	65	20	ZYA-S	•
12	6	70	25	ZYA-S	•
10	6	65	20	WRC	•
12	6	70	25	WRC	•
10	6	65	20	SPG	•
12	6	70	25	SPG	•
10	6	65	20	RBF	•
12	6	70	25	RBF	•
10	6	53	8	KUD	•
12	6	67	25	SKM	•

MX

P.1 P.2 P.3 P.4 P.5 P.6 K.1 K.2 N.1 N.2 N.3 N.4 S.1 S.2

Contour end mills for plastics



CZ Obrysové frézy na plasty | na plasty

DE Konturenfräser für Kunststoffe

RU Бор-Фрезы твердосплавные

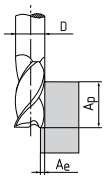
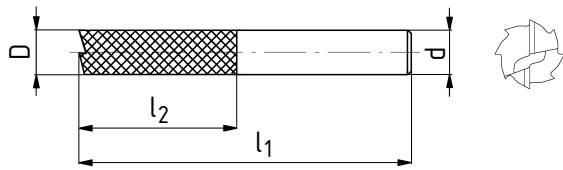

T2002



D	d	l1	l2	Z	T2002
2	3	40	9	2	.020
3	3	40	12	2	.030
4	4	50	16	2	.040
6	6	50	19	2	.060
6	6	100	40	2	.060100
8	8	60	25	2	.080
8	8	100	40	2	.080100
10	10	70	25	2	.100
10	10	100	40	2	.100100
12	12	75	25	2	.120
12	12	100	40	2	.120100

Cutting conditions | Řežné podmínky | Schnittbedingungen | Условия резания

Material	Ap	Ae	Vc	fz (mm/z)						
				Ø 3	Ø 4	Ø 5	Ø 6	Ø 8	Ø 10	Ø 12
N.5 ≤ 300 N/mm ²	1,5xD	0,1xD	90	0,02	0,02	0,027	0,027	0,054	0,072	0,089